

# HOME SCREENING KIT INSTRUCTIONS

- There are no dietary restrictions. Eat and drink normally.
- The kit is a two day kit. Only a **small** sample of stool is needed each day.
- If you do not have a bowel movement every day, that's ok.
- This is your kit. Do not give this kit to someone else.

## WHEN YOU ARE READY:

### FIRST SAMPLE

- 1 Take one collection card from the kit envelope.

- Write the collection date (the date of the sample) on the card.

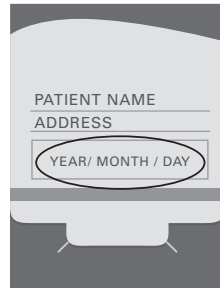

- Open the card.

You are now ready to take the sample.

- 2 Collect the stool in a clean dry container or plate, or use the tissue paper in the kit. Do not let the stool touch the water in the toilet bowl.

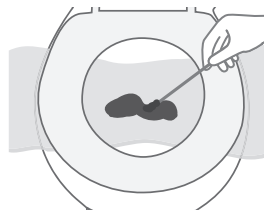

- 3 Use the wooden stick from the kit to take a tiny sample from one part of the stool.

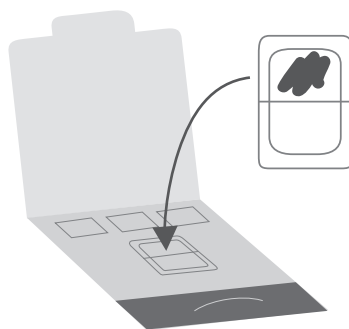

- 4 Put the tiny sample on the top half of the collection window on the inside of the card.

- 5 Using the same stick, take another tiny sample from a different part of the same stool.

- 6 Put the tiny sample on the bottom half of the same collection window.

- 7 Use the stick to mix the top and bottom samples together.

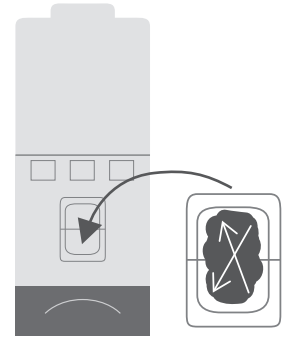

- 8 Close the flap and set the card aside to air dry overnight before putting it in the barrier pouch.

- 9 Throw the stick and collection container in the garbage and flush the stool that is left.

### SECOND SAMPLE

Repeat steps 1-9 with a separate bowel movement on a different day.

### MAILING YOUR COMPLETED KIT TO THE LAB

- 1 When both samples have dried overnight, place them in the barrier pouch.

- 2 Use the return envelope to mail the barrier pouch and the participant form to the lab **within 10 days** of the first collection date.

### The lab will **NOT** process your kit if:

- Either stool sample is older than 10 days.
- The stool sample is not placed in the collection window.
- You do not write the collection date on the card.

IF YOU HAVE ANY QUESTIONS  
ABOUT HOW TO COMPLETE THE KIT,  
CALL 1-866-599-2267